



J22/25/30/40金属按钮开关

Metal Button Switch

J30 带灯金属按钮开关

J30 Metal button switch with lamp

外观 Appearance	头部形状 Shape of top	带灯形式 Illuminated type	操作类别 Operation	触点 Contact	产品型号 Model	灯珠颜色 Color	灯珠电压 Voltage	外壳材料 Crust material
	高面环形圆形 High ring round	带灯 With LED	自复 Momentary	1NO+1NC	J30-261 □ ●	请用下列编码替换 型号中的“□” R 红色/Red G 绿色/Green B 蓝色/Blue W 白色/White Y 黄色/Yellow O 橘色/Orange	请用下列编码替换 型号中的“●” D: 24VDC E: 12VDC F: 6.3VDC A1: 110VAC A2: 220VAC	空: 不锈钢 T: 铜镀铬 Blank: Stainless steel T: Copper plated Cr
				2NO+2NC	J30-262 □ ●			
			自锁 Maintained	1NO+1NC	J30-361 □ ●			
				2NO+2NC	J30-362 □ ●			
	实面环形圆形 Flat ring round	带灯 With LED	自复 Momentary	1NO+1NC	J30-271 □ ●			
				2NO+2NC	J30-272 □ ●			
			自锁 Maintained	1NO+1NC	J30-371 □ ●			
				2NO+2NC	J30-372 □ ●			
	实面点头圆形 High point round	带灯 With LED	自复 Momentary	1NO+1NC	J30-281 □ ●			
				2NO+2NC	J30-282 □ ●			
			自锁 Maintained	1NO+1NC	J30-381 □ ●			
				2NO+2NC	J30-382 □ ●			
	弧面环形圆形 Domed ring round	带灯 With LED	自复 Momentary	1NO+1NC	J30-2A1 □ ●			
				2NO+2NC	J30-2A2 □ ●			
			自锁 Maintained	1NO+1NC	J30-3A1 □ ●			
				2NO+2NC	J30-3A2 □ ●			

外形尺寸图 Dimensions

高位钮带灯



单刀/1Pole
双刀/2Pole

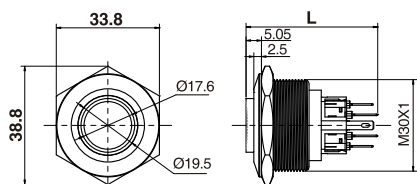

L: J30自复 43.15mm
J30自锁 44.8mm

平钮带灯



单刀/1Pole
双刀/2Pole

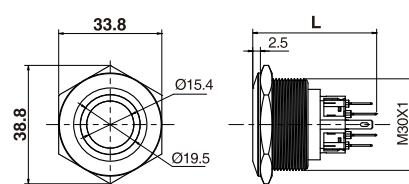

L: J30自复 40.6mm
J30自锁 42.25mm

平钮带点头灯



单刀/1Pole
双刀/2Pole

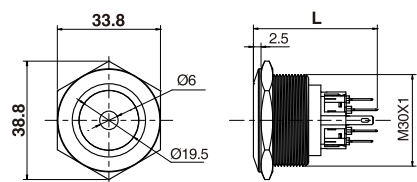

L: J30自复 40.6mm
J30自锁 42.25mm

弧钮带灯



单刀/1Pole
双刀/2Pole

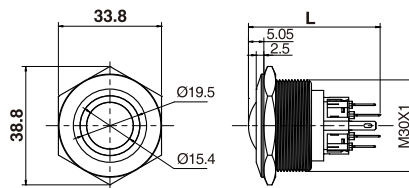

L: J30自复 43.15mm
J30自锁 44.8mm