



# J19金属按钮开关

## Metal Button Switch

### J19 急停按钮

#### J19 Emergency Stop Button

外观 Appearance	头部形状 Shape of top	操作类别 Operation	安装方法 Method	开关组合 Contact Configuration	触点 Contact	产品型号 Model	外壳材料 Crust material
	急停按钮 Emergency Stop Button	推锁旋放式 Push-lock Turn-reset	拆装式 Combined Structure	1NO 1NC 2NO 2NC	单刀/SPDT	<b>J19-811</b>	不锈钢 Stainless steel
					双刀/DPDT	<b>J19-812</b>	
	急停按钮 Emergency Stop Button	推锁旋放式 Push-lock Turn-reset	拆装式 Combined Structure	1NO 1NC 2NO 2NC	单刀/SPDT	<b>J19-A11</b>	不锈钢 Stainless steel
					双刀/DPDT	<b>J19-A12</b>	

#### 外形尺寸图 Dimensions

急停按钮

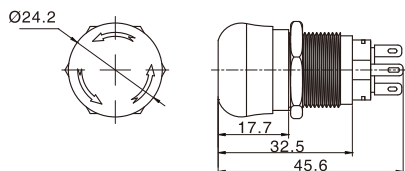

急停按钮

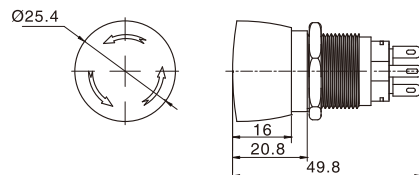

### 连接器

#### Connector

外观 Appearance	按钮型号 Button type	主触点 Main contacts	带灯类型 Illuminated type	产品型号 Model
	<b>J19</b>	1组 1pair	J19连接器单刀不带灯	<b>J19-3P</b>
			J19连接器单刀带灯	<b>J19-5P</b>
		2组 2 pair	J19连接器双刀不带灯	<b>J19-6P</b>
			J21连接器双刀带灯	<b>J19-8P</b>

#### 连接示意图 Connection diagram

