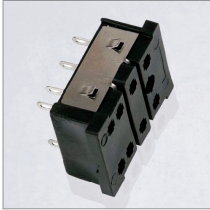

性能参数 / Parameter

类型/Name	18F继电器插座 / 18F Relay socket	
型号/Type	18F-2Z-A1	18F-2Z-A2
外观/Appearance		
Rated current / Rated voltage	10A/300V	
Dielectric strength adjacent contact circuits	1500	
Conductor cross section solid and stranded		
Conductor cross section(A.W.G)		
Stripping length		
Screw Thread		
Ambient temperature (operation)	-25℃~+85℃	

ZJ18F/N

JH41F

ZJ18F/ZJ18FT

ZJ14F/ZJ14FW

ZJ10F

ZJ13F

其它继电器插座

ZJ3F

ZJT90

ZJT93

附件

ZJ18F

继电器

ZJ18FT

继电器

18F

继电器插座

18F-2Z-A1

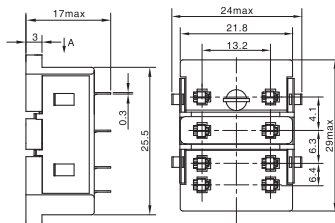

接线图 /Wiring Diagram

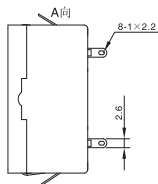

18F-2Z-A2

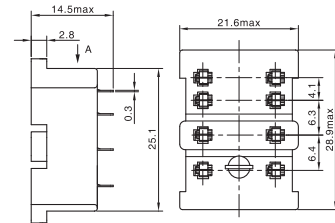

接线图 /Wiring Diagram

